



安装说明

INSTALLATION INSTRUCTIONS

# E系列货物稳定器 E-Series Load Stabilizer



官方微信号 天猫旗舰店



服务热线

Customer Service Hotline

40088 57315



# 目录 CONTENTS

|         |                                       | 页码<br>Page |
|---------|---------------------------------------|------------|
| 介绍      | INTRODUCTION                          | 1          |
| 对叉车的要求  | TRUCK REQUIRMENTS                     | 2          |
| 推荐供油系统  | RECOMMENDED HYDRAULIC SUPPLY          | 3          |
| 安装侧移器   | INSTALLATION SIDESHIFTER(IF EQUIPPED) | 4          |
| 安装货物稳定器 | INSTALLATION LOAD STABILIZER          | 6          |
| 调压阀     | RELIEF VALVE                          | 10         |
| 操作前     | PRIOR TO OPERATION                    | 11         |
| 定期维护保养  | PERIODIC MAINTENANCE                  | 13         |
| 备件      | PARTS                                 | 15         |

**重要提示：**现场改动将减弱属具的性能或承载能力，并导致失去保修资格。如需对属具进行改动，请事先与卡斯卡特（厦门）公司协商。



**IMPORTANT:** Field alterations may impair performance or capability and could result in loss of warranty. Consult Cascade for any required modifications.

# 介绍 / INTRODUCTION

本手册为卡斯卡特E系列货物稳定器提供了安装说明。关于货物稳定器的任何信息都要追溯到铭牌上的产品编号。如果铭牌丢失，则可以在铭牌下方找到刻在上面的产品编号。

**重要提示：** E系列货物稳定器上的软管，钢管以及接头都符合JIC标准。

**注意：** 所有的参数都有英制和公制两种。

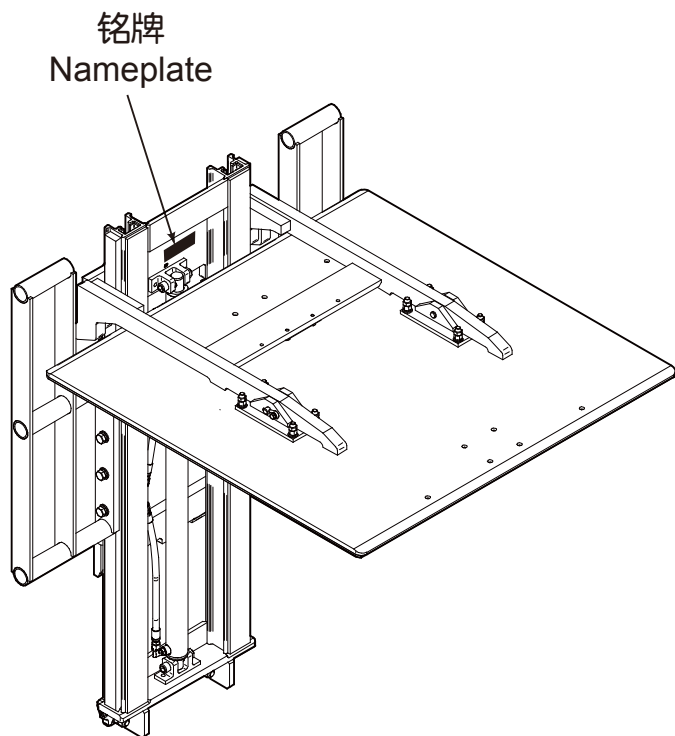

This manual provides installation instructions for Cascade E-Series Load Stabilizer .

In any communication about the Load Stabilizer refer to the product I.D. number stamped on the nameplate. If the nameplate is missing, the numbers can be found stamped below the .

**IMPORTANT:** All hoses, tubes and fittings on E-Series Load Stabilizer are JIC.

**NOTE:** Specifications are shown in both U.S. and (Metric) units.

新铭牌 New Nameplate

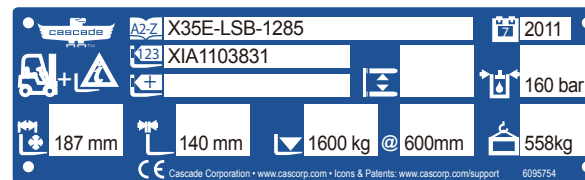

旧铭牌 Old Nameplate

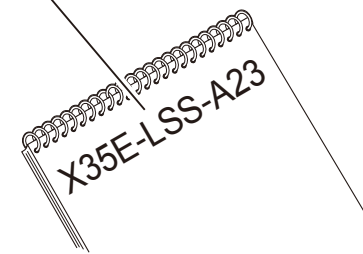
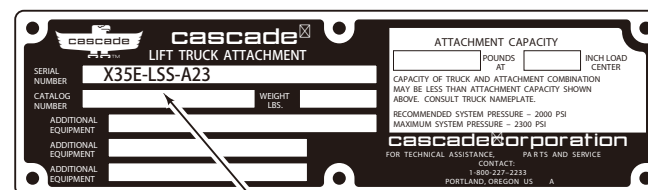

# 对叉车的要求 **T**RUCK REQUIREMENTS

叉车供油压力 Truck Relief Setting  
 最大值(Maximum Pressure): 160bar

叉车供油流量 Truck Flow Volume

|      | 最小值Min            | 推荐值Recommended    | 最大值Max             |
|------|-------------------|-------------------|--------------------|
| X35E | 19L/min<br>(5GPM) | 30L/min<br>(8GPM) | 38L/min<br>(10GPM) |

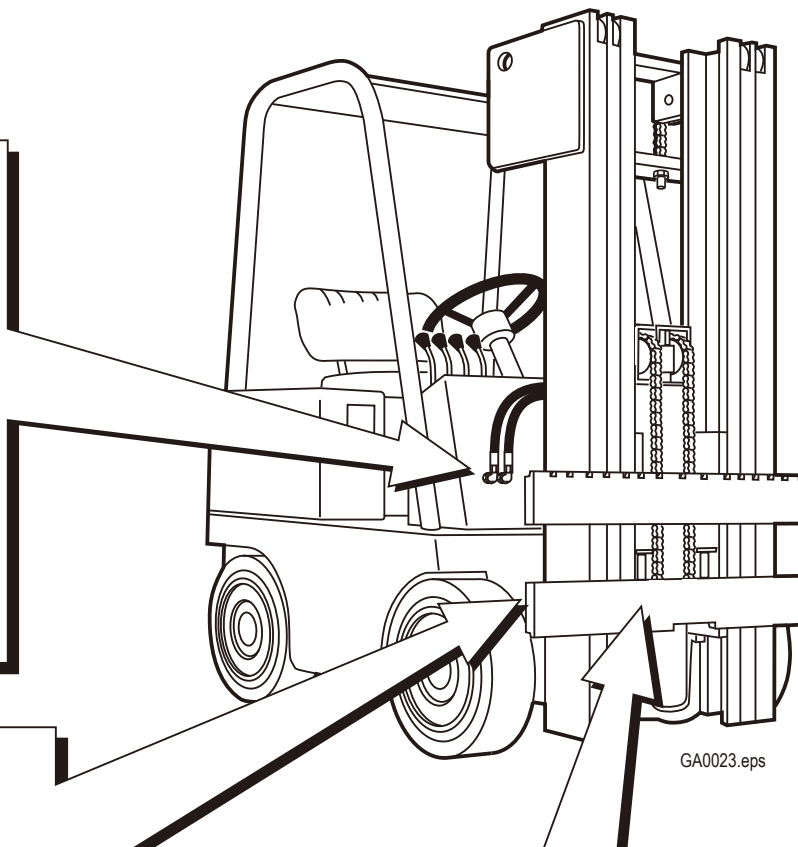

GA0023.eps

货叉架安装尺寸 (A) ITA (ISO)  
 Carriage Mount Dimension (A) ITA (ISO)

| A         |  | 最小值Minimum          | 最大值Maximum          |
|-----------|--|---------------------|---------------------|
| Class II  |  | 380.0 mm (14.94in.) | 381.0 mm (15.00in.) |
| Class III |  | 474.5 mm (18.68in.) | 476.0mm (18.74 in.) |

**货叉架**

清理并货叉架并检测横梁的破损情况。

**Carriage**

Clean carriage bars and inspect for damage notches.

货物稳定器

非侧移式

A 右侧两管式细管卷管器

或

B 内系同步油路

带侧移式 (货物稳定器不带电磁阀)

A 和 B 右侧两管式细管卷管器和内系同步油路

或

A 右侧四管式卷管器

带侧移式 (货物稳定器带电磁阀)

A 右侧带电缆卷管器

或

A 和 B 带电缆卷管器和内系同步油路

**Load Stabilizer**

**Non-Sideshifting**

A RH THINLINE™ 2-Port Hose Reel Group

or

B Mast Internal Reeving

**Sideshifting(Non-Solenoid Activated Load Stabilizer)**

A and B RH THINLINE™ 2-Port Hose Reel Group and Mast Internal Reeving

or

A RH THINLINE™ 4-Port Hose Reel Group

**Sideshifting(Solenoid Activated Load Stabilizer)**

A RH 6-N-1 Cable/Hose Reel Supply Group

or

A and B RH Cable Reel Supply Group and Mast Internal Reeving

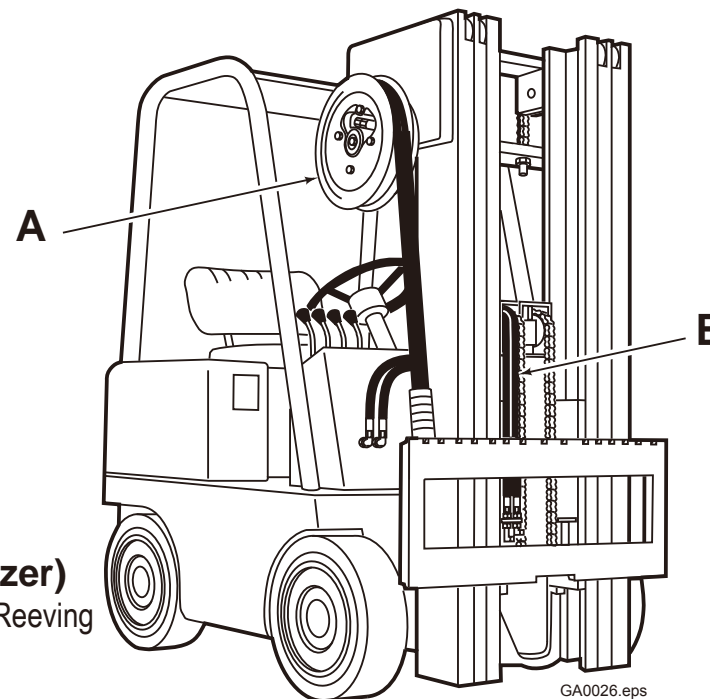

GA0026.eps

# 安装侧移器 (如果需要)

# INSTALLATION SIDESHIFTER (IF EQUIPPED)

**1** 从箱体中取出来  
Remove From Box

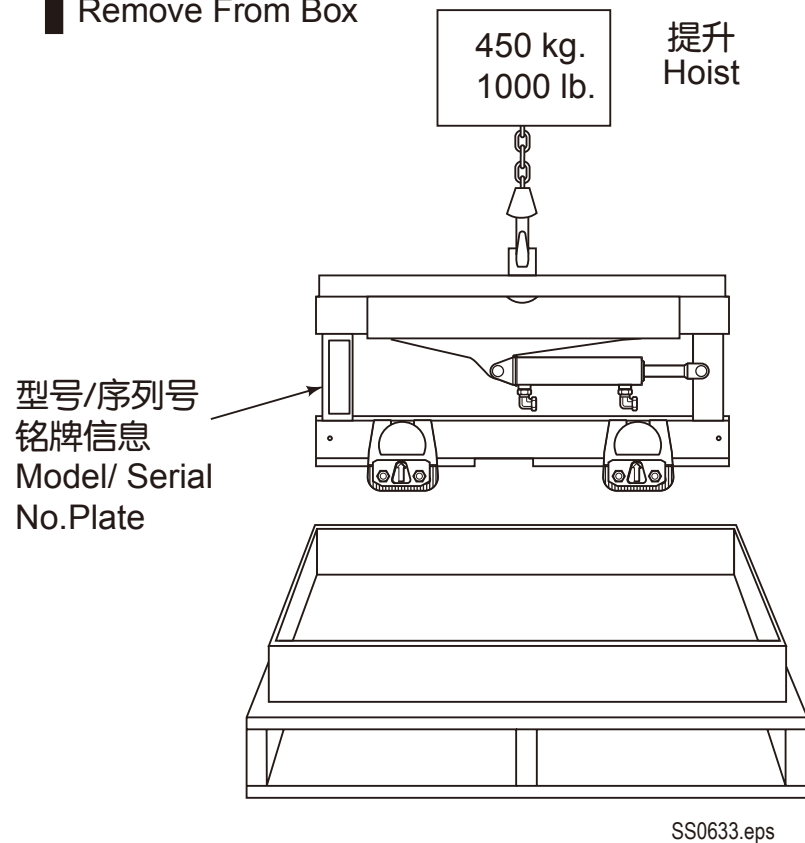

警告：确保起吊设备的额定承载能力不低于450kg(1000lbs)  
WARNING: Make sure overhead hoist has a rated capacity of least 450(1000lbs).

**2** 拆卸下钩  
Remove Lower Hooks

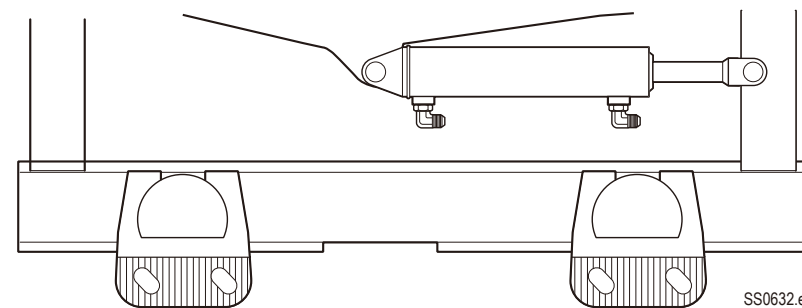

SS0632.eps

背面 (从驾驶员的角度看)  
Back(Drive's)Views

# 安装侧移器 (如果需要)

# INSTALLATION SIDESHIFTER (IF EQUIPPED)

## 3 将侧移器挂装在叉车货叉架上 Mount Sideshifter on truck carriage

- 二级安装 ITA-15-17mm
- 三级安装 ITA-18-20mm
- 四级安装 ITA-18-20mm

- ITA Class II -15-17mm(0.60-0.66in.)
- ITA Class III -18-20mm(0.72-0.78in.)
- ITA Class IV -18-20mm(0.72-0.78in.)

使定位销能够卡到  
中心位置的凹槽里  
Engage locator tab with center notch

如果需要的话卸下油缸  
Remove Cylinder if necessary

- 二级安装 ITA-8-9mm
- 三级安装 ITA-10-11mm
- 四级安装 ITA-12-13mm

- ITA Class II -8-9mm(0.32-0.36in.)
- ITA Class III -10-11mm(0.39-0.43in.)
- ITA Class IV -12-13mm(0.47-0.51in.)

叉车货叉架上横梁  
Truck Upper Carriage Bar

SS0283.eps

## 4 安装下钩 Install lower hooks



提起下钩  
Raise hook

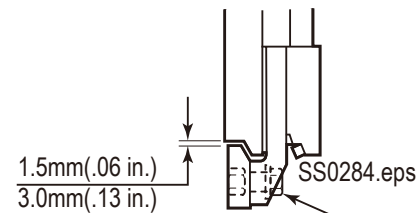

扭矩155-170Nm  
Torque to 155-170Nm.  
(115-125 ft.-lbs)



# 安装货物稳定器

# INSTALLATION STABILIZER

## 1 起吊属具 Attach overhead hoist

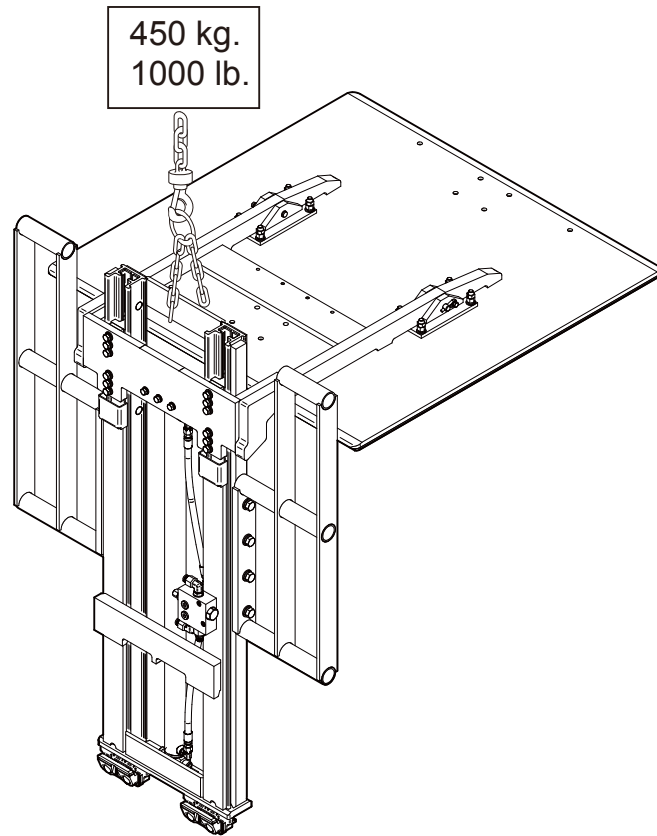

## 2 拆卸下钩 Remove lower Hook

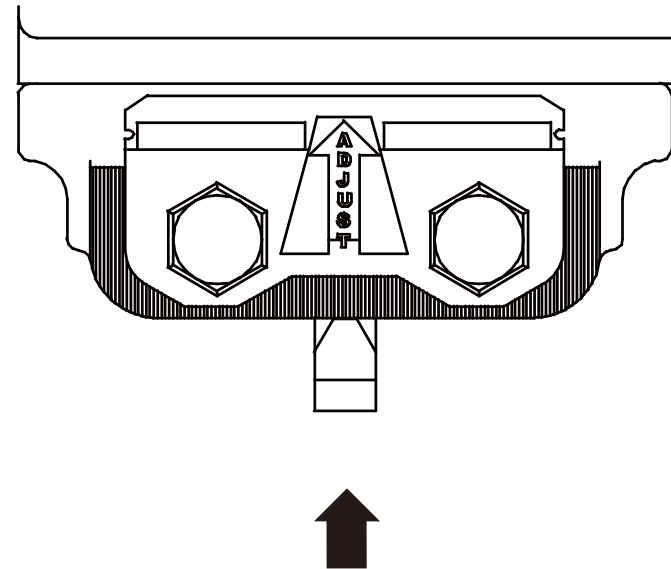

# 安装货物稳定器

# INSTALLATION STABILIZER

## 3 挂装到叉车上 Mount on lift truck

将属具与叉车  
货叉架对中  
Center on Carriage  
叉车货叉架  
中部的凹槽  
Truck carriage  
center notch

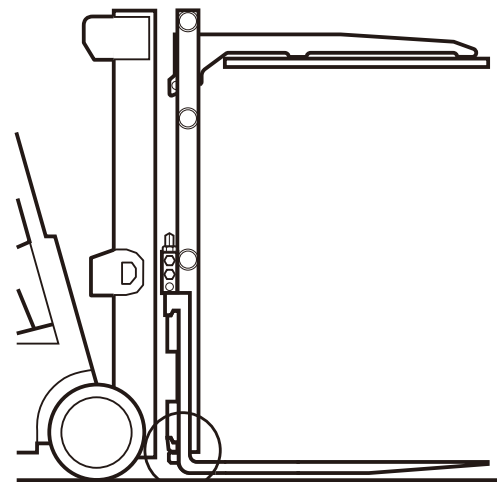
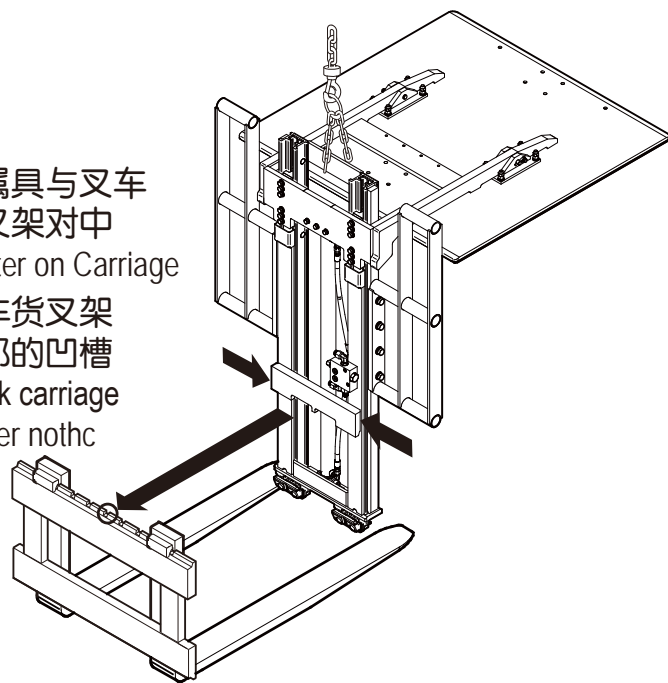

## 4 锁紧下钩 Install lower hooks

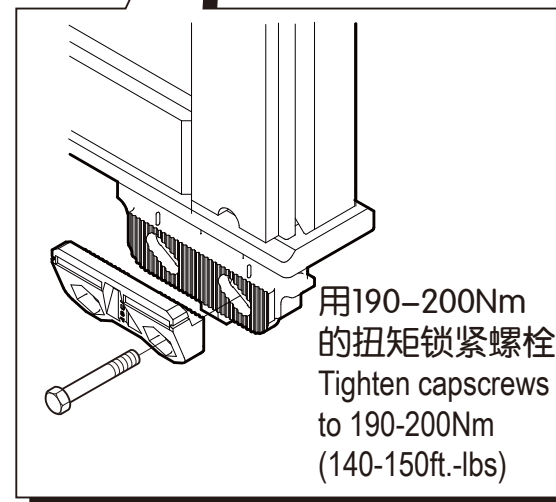

用190-200Nm  
的扭矩锁紧螺栓  
Tighten capscrews  
to 190-200Nm  
(140-150ft.-lbs)

# 安装货物稳定器

# INSTALLATION STABILIZER

## 5 多路阀功能 Auxiliary Valve Functions

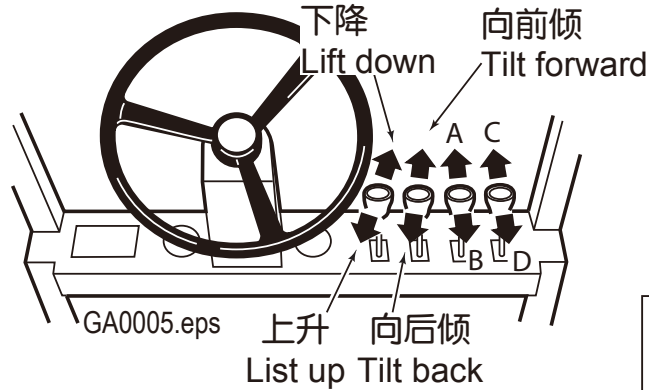

### 货物稳定器 (侧移式)

- A 左侧移
- B 右侧移
- C 稳定器压板上升
- D 稳定器压板下压

### LOAD STABILIZER SIDESHIFTING

- A Sideshift Left
- B Sideshift Right
- C Stabilizer Up
- D Stabilizer Down

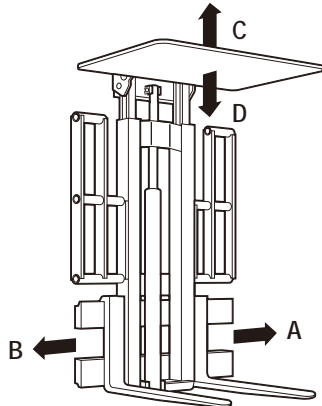

### 货物稳定器 (非侧移式)

- A 货物稳定器压板上升
- B 货物稳定器压板下压

### LOAD STABILIZER NON SIDESHIFTING

- A Stsbilizer Up
- B Stabilizer Down

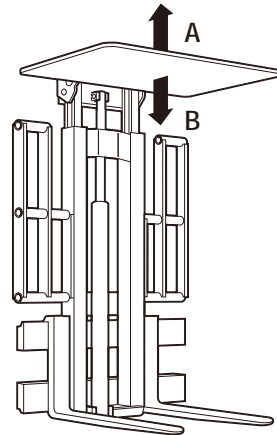

### 货物稳定器 (侧移式, 带电磁阀)

- A 左侧移
- A 稳定器压板上升 (按下手柄按钮)
- B 右侧移
- B 稳定器压板下降 (按下手柄按钮)

### LOAD STABILIZER -SOLENOID ACTIVATED SIDESHIFTING

- A Sideshift Left
- A Stabilizer Up (press knob button)
- B Sideshift Right
- B Stabilizer Down (press knob button)

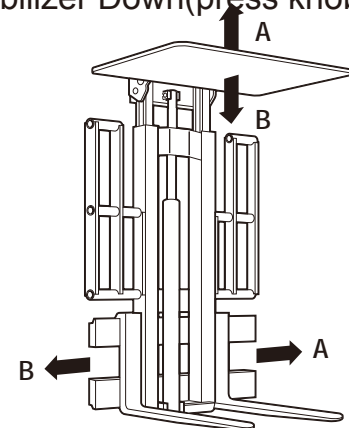

## 6 侧移器速度调节 Sideshift speed adjust

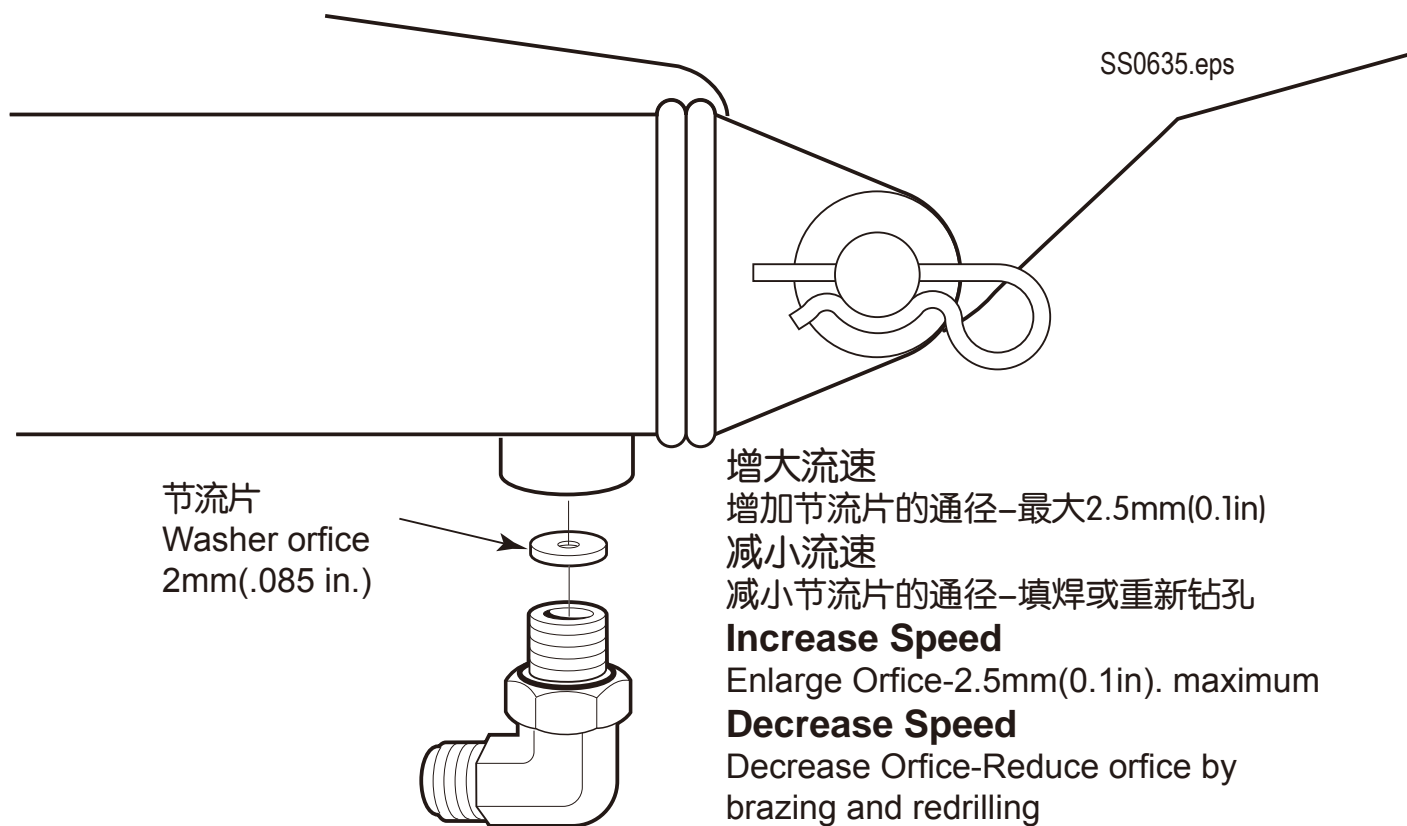

# 调压阀 **R** ELIEF VALVE

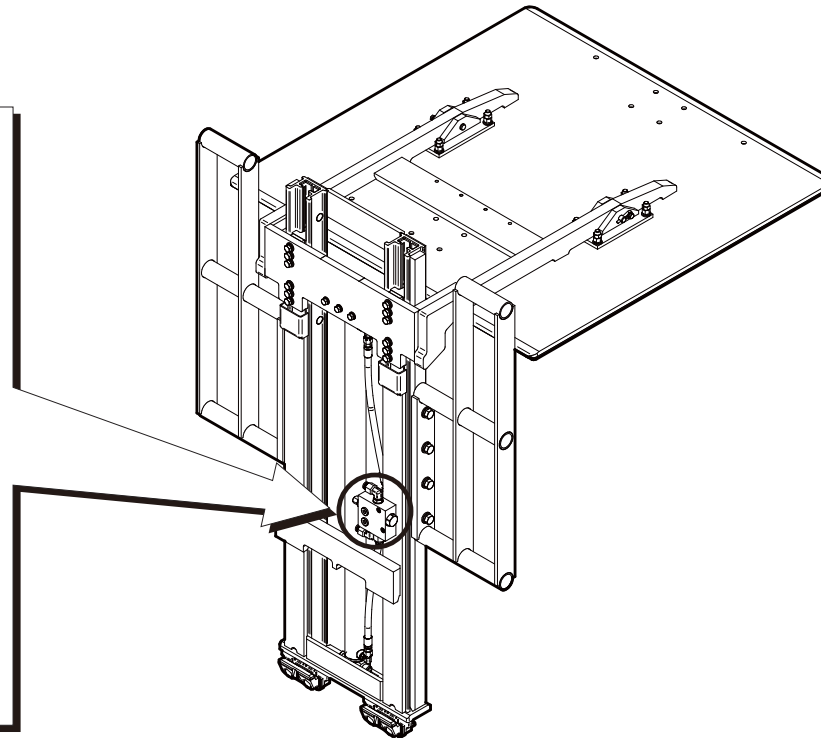
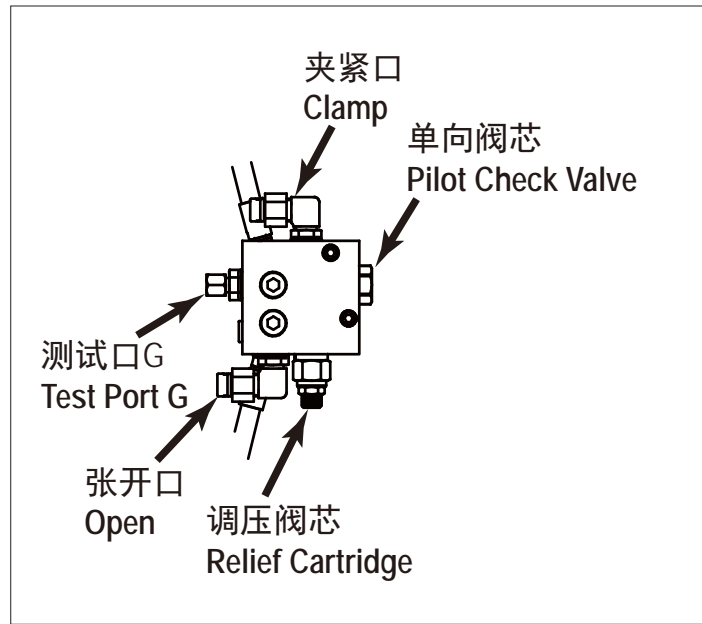

叉车压力：最大允许值160bar;

叉车流量：推荐值 $30 \pm 8$ L/min;

在出厂前，通过调节调压阀芯，使测试口“G”的压力值设定为 $60 \pm 10$ bar，  
用户在使用前根据实际的工况对压力进行调整。

Truck Relief Setting: 160bar Maximum

Truck Flow Volume:  $30 \pm 8$ L/min

Make sure the pressure to the test port “G”  $60 \pm 10$ bar by setting relief cartridge before delivery, users should adjust the pressure in terms of application before they use.

# 操作前 **P**RIOR TO OPERATION

## 1 测试各种功能

- A 提升压板
- B 保持叉车多路阀打开状态10秒钟，以便将内部的空气排出
- C 如果带有侧移器的话，则重复侧移动作若干次

### Test functions

- A Raise Stabilizer
- B Hold truck valve open 10 seconds to remove air
- C Repeat for sideshift(if required)

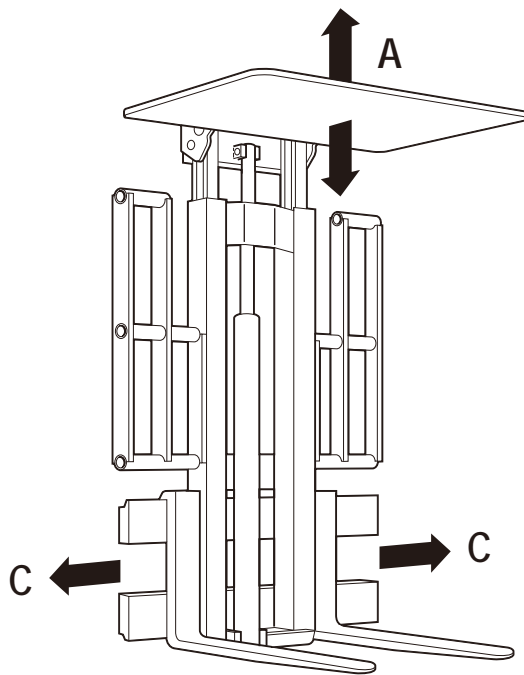

## 2

根据工况调整夹持力的大小

需要夹紧力增大时，则将阀芯按顺时针方向旋进

### Clamp force adjustment by application

Turn relief cartridge counterclockwise if need increasing clamp force

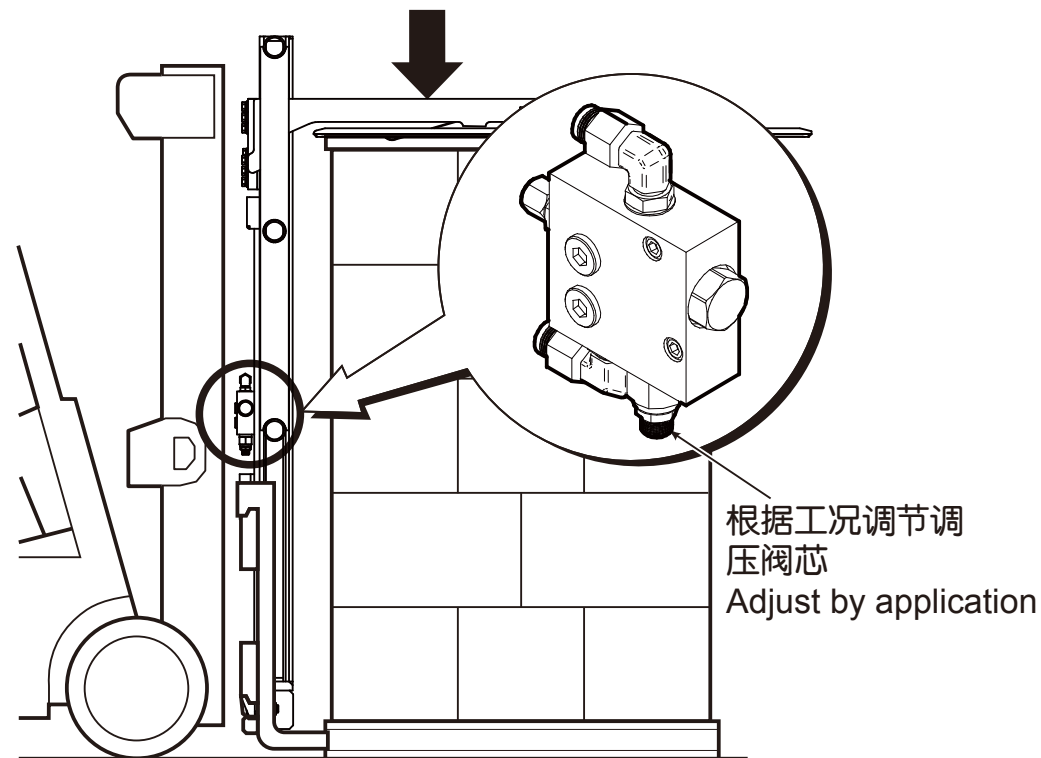

LS0037.eps

# 操作前 **P** RIOR TO OPERATION

## 3 夹臂操作和调整 Arm operation and adjustment

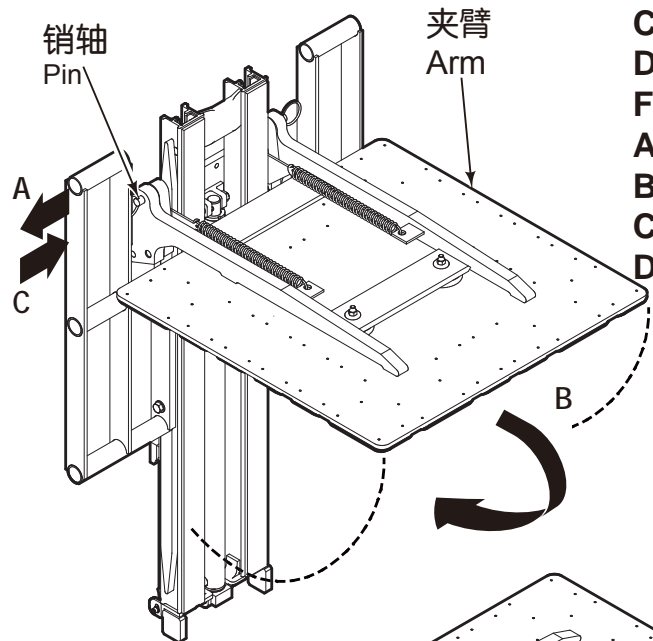

- 折叠式夹臂  
**A** 抽出销轴  
**B** 向下折叠夹臂  
**C** 装上销轴  
**D** 重新将夹臂向上翻

### Fold-down Arm

- A** Pull out pins  
**B** Fold down arm  
**C** Install pins  
**D** Reverse for fold-up

调整后带动  
夹臂运动  
Adjust to take up  
arm movement

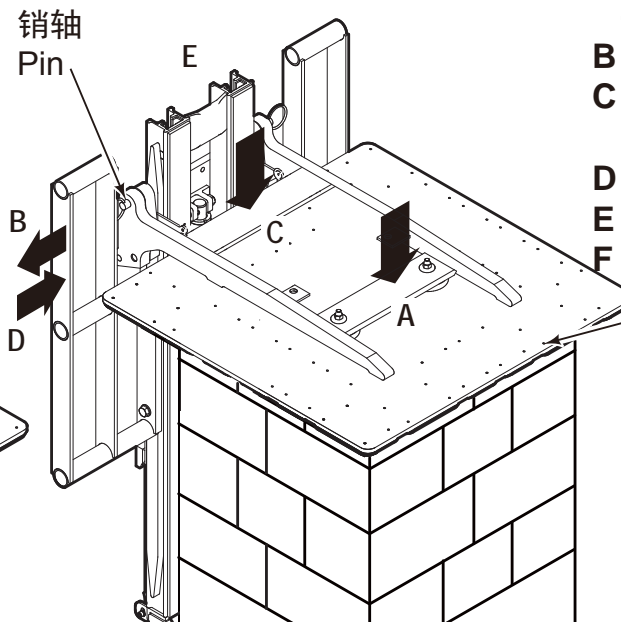
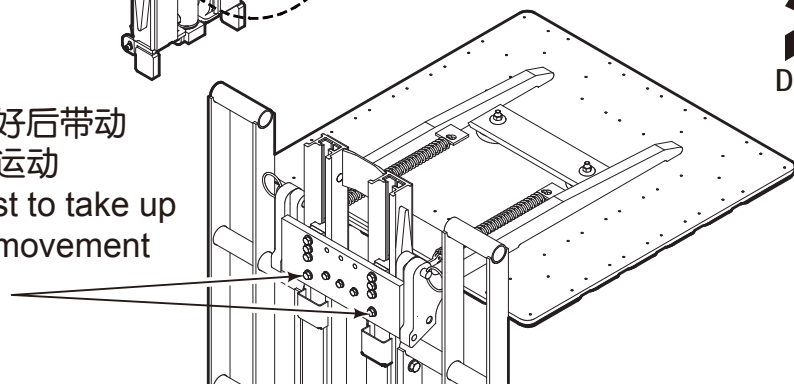

### 快速更换夹臂

- A** 将夹板停靠在堆垛上  
**B** 抽出销轴  
**C** 通过操纵多路阀以降低压板框架  
**D** 安装销轴  
**E** 将货物稳定器向后退  
**F** 按照拆卸步骤相反的顺序重新安装夹臂

### Quick change Arm

- A** Position the arm resting on a stack  
**B** Pull out pins  
**C** Actuate control valve to lower the arm carrier  
**D** Install pins  
**E** Back away  
**F** Reverse for installation

# 定期维护保养

# PERIODIC MAINTENANCE

## 每天保养

每天检查图中所示的检测项目.向你的主管汇报其中相关问题.参考维修手册按照保养和维修程序查出并解决问题.

- 检查压板锁紧螺钉有无松动,若有用50-55Nm的力矩锁紧螺钉。

## 100小时保养

叉车每次维修或叉车每使用100小时后(以先到达为准),需完成如下保养内容:

- 检查货物稳定器下钩,用25-27Nm的力矩锁紧下钩侧面螺栓。用190-200Nm的力矩锁紧下钩螺栓。
- 检查压板锁紧螺钉有无损坏,若有及时更换。

## 500小时保养

叉车在工作500小时以后,除了已有的100小时保养以外,还要按照以下程序进行保养:

- 用通用的底盘润滑脂对货物稳定器的滑杆进行润滑。

## 1000小时保养

叉车在使用1000小时以后,除了已有的100小时和500保养,还要按照以下程序进行保养:

- 检查滑动支承露出部分的厚度。如果滑动支承露出部分的厚度磨损到小于3mm时,请将滑动支承整个更换。

## 2000小时保养

叉车在工作500小时以后,除了已有的100小时,500小时和1000小时保养以外,还要按照以下程序进行保养:

- 更换货物稳定器夹臂的滑动支承。

**警告:**在完成任何检测过程之后,通过完成5次的往复循环动作来检测所有的功能。然后空载试车,车投入正常工作之前必须事先负载测试以确保正常工作。

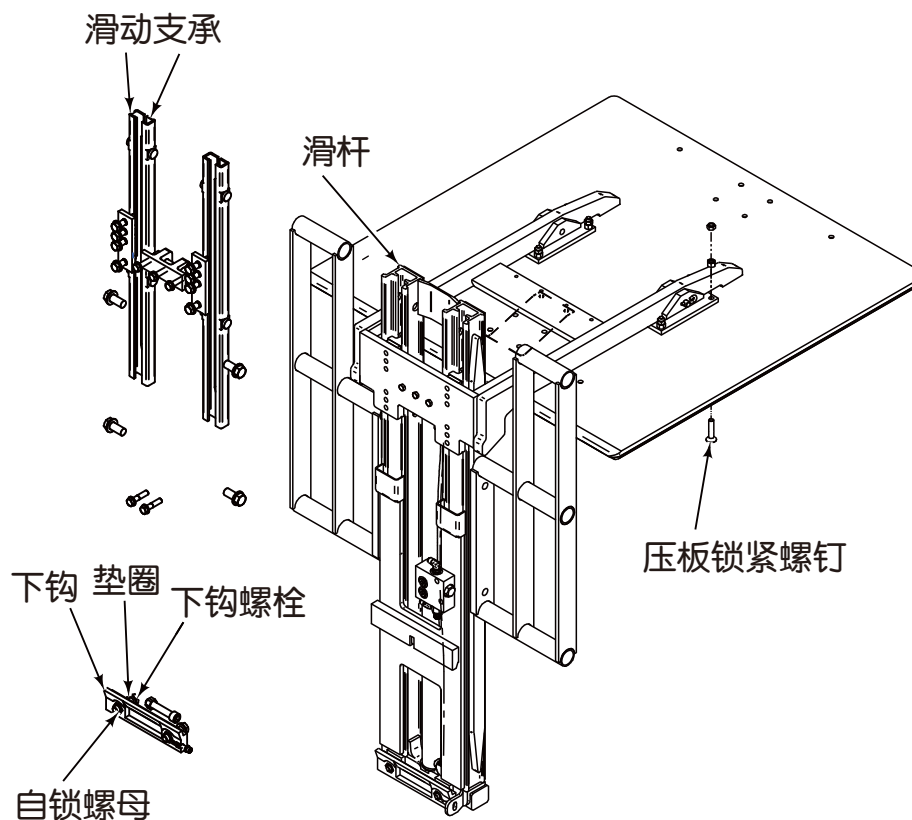



# 定期维护保养

# PERIODIC MAINTENANCE

## Daily

Check items shown each day. Report problems to your supervisor.

See Service Manual for troubleshooting, maintenance and repair procedures.

- Inspect the Plate capscrews. Tighten the Plate capscrews to a torque of 50-55Nm.

## 100 Hour Maintenance

Every time the lift truck is serviced or every 100 hours of truck operation, whichever comes first, complete the following maintenance procedures:

- Inspect the load stabilizer lower hooks. Tighten the side capscrew to a torque of 25-27 Nm (18-20 ft.-lbs). Tighten the hook capscrews to a torque of 190-200 Nm (140-150 ft.-lbs).
- Inspect the Plate capscrews. If the Plate capscrews is worn, replace them.

## 500 Hour Maintenance

After 500 hours of lift truck operation, in addition to the 100 hour maintenance, perform the following procedures:

- Apply chassis grease to the load stabilizer arm bars.

## 1000 Hour Maintenance

After 1000 hours of lift truck operation, in addition to the 100 and 500 hour maintenance

procedures, perform the following procedures:

- Inspect the exposed thickness of the arm bar bearings. If the exposed thickness is worn to less than 3 mm (1/8 in).

## 2000 Hour Maintenance

After each 2000 hours of lift truck operation, in addition to the 100, 500 and 1000 hour maintenance, perform the following procedures:

- Replace the load stabilizer arm bearings.

**IMPORTANT:** After completing any service procedure, test each function through 5 complete cycles. First test the attachment empty, then test each function with a load to make sure the attachment operates correctly before returning it to the job.

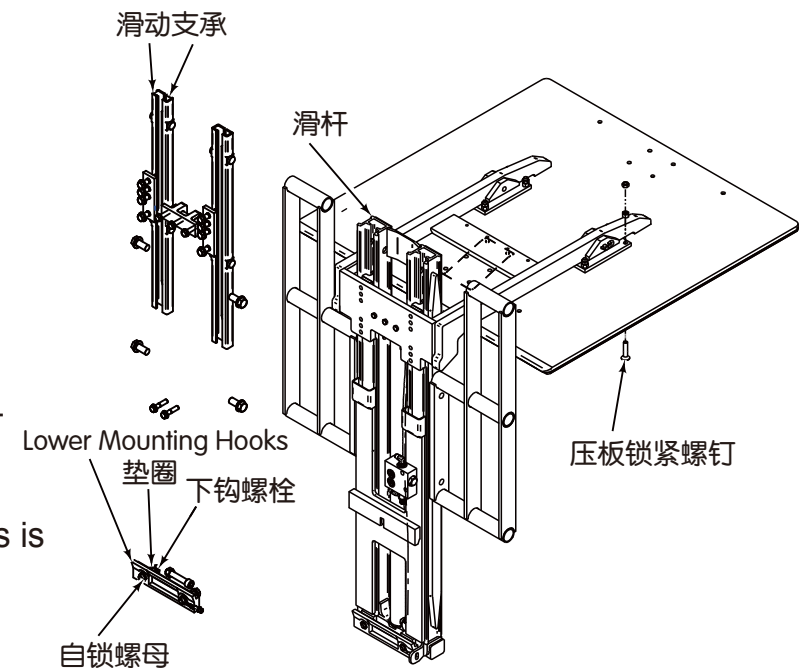

## 推荐备件清单 Recommended Spare Parts List

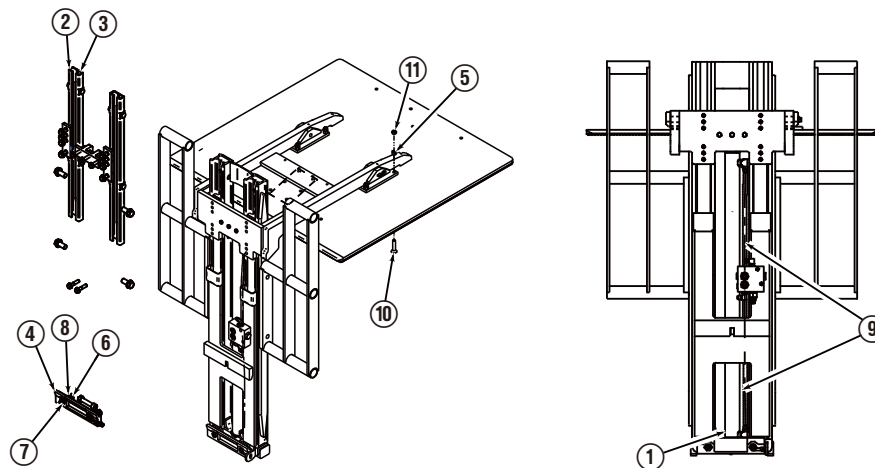

| X35E-LSB 货物稳定器推荐备件清单-- R-2 |         |                            |                       |       |        |
|----------------------------|---------|----------------------------|-----------------------|-------|--------|
| 序号                         | 零件号     | 名称                         | 推荐备件数量 UNITS SERVICED |       |        |
|                            |         |                            | 1~5台                  | 6~19台 | 20~50台 |
| 1                          | 562447  | 油缸维修包 Cylinder Service Kit | 1                     | 2     | 4      |
| 2                          | 667906  | 滑动支承 Bearing, L=660mm      | 2                     | 4     | 8      |
| 3                          | 667907  | 滑动支承 Bearing, L=660mm      | 2                     | 4     | 8      |
| 4                          | ■       | 下钩 Lower Hook              | 0                     | 2     | 4      |
| 5                          | 1250057 | I型六角螺母 Nut, M12            | 0                     | 1     | 2      |
| 6                          | 1250086 | 下钩螺栓 C/S-HH, M16×45        | 2                     | 4     | 8      |
| 7                          | 1250067 | 平垫圈 Washer, M16            | 2                     | 4     | 8      |
| 8                          | 678990  | 自锁螺母 Self Lock Nut, M16    | 2                     | 4     | 8      |
| 9                          | ■       | 油管                         | 2                     | 4     | 8      |
| 10                         | 1250125 | 压板锁紧螺钉 FHCS, M12×60        | 2                     | 4     | 8      |
| 11                         | 773842  | 锁止螺母 Self Lock Nut, M12    | 2                     | 4     | 8      |

- 详细零件号参见具体型号货物稳定器。
- See specific model Load Stabilizer for part number.



# 卡斯卡特（厦门）叉车属具有限公司

## Cascade Xiamen Forklift Truck Attachment Co.Ltd

地址：厦门市海沧区阳光路668号 邮编：361026

No. 668 Yangguang Road, Haicang, Xiamen, Fujian, 361026 P.R China

电话/Tel: 0592-6512500 传真/Fax: 0592-6512571

**cascade corporation**

**www.cascorp.com.cn**

卡斯卡特（厦门）公司保留对本手册修改的权利，如有修改，恕不另行通知。  
Cascade Xiamen reserves the rights to make change without notice.

1210963 R3 XM CN 11/2015